

We have the goods at

THE LITTLE GREEN DOOR

On the Highway near Santa Cruz Avenue.

MENLO PARK

Department 1

Department 2

Department 3

Ice Cream and Sweets Soft Drinks Cakes and Confections	GENTS' Furnishings School Supplies Boys' Caps Sporting Goods Kodaks, Films Developing	TOBACCO Cigarettes Cigars Smokers' Articles Cutlery Clocks Shaving Accessories
---	---	--

Phone
Menlo 290

Fred Nessler, Proprietor
Pleased to meet you.

Telephone Menlo 190

W. D. Packwood Co.

DUFF & DOYLE BUILDING
MENLO PARK

Leading Grocers

GENERAL MERCHANDISE

Quality, Service, Promptness

We respectfully solicit your patronage
Thank you

Telephone Palo Alto 214.

P. O. Box 82.

West Coast Nursery Co.

LANDSCAPE ENGINEERS

Palo Alto, California.

Growers of High Grade Nursery Stock
Nurseries State Highway and San Francisquito Creek

HORTICULTURAL SERVICE

First Class Work.

Phone P. A. 523.

Palo Alto Laundry Co.

MENLO PARK

Special attention given to ladies' and gentlemen's goods washed
by hand. Orders promptly attended to.
State Highway near Oak Grove Avenue.

THE REFRESHERY

CANDIES—ICE CREAM—SANDWICHES

On the Highway opposite Santa Cruz Avenue.

ED BENNETT

New York Life Insurance Co.

GEORGE B. WALSH

Representative for San Mateo County

Residence, Menlo Park. Phone Menlo Park 1512.

MENLO PARK

Menlo Park and Atherton are not incorporated. Houses are not numbered, so merely the streets are given along which houses are located. For the same reason it is impracticable to compile a street directory, but the streets are listed and their locations given. In cases of residents some distance from the postoffice who receive their mail by rural free delivery the box numbers are given. Menlo Park is a home and school center. It has quite a number of business places and several organizations and a number of churches. These are:

Menlo Park Fire Commission—A. G. C. Hahn, C. R. Walter, C. H. Merrill. Fire station on Merrill avenue near Southern Pacific station.

Menlo Park Grammar School—Trustees, James G. Mason, M. Polson, A. W. Gale; teachers, Principal W. S. Bower, Miss Blanche Clark, Mrs. Ivy Locklin, Miss Bertha Kuck. School on El Camino Real between Oak Grove and Glenwood.

Las Lomas School, Alameda de las Pulgas—Trustees, Prof. P. E. Davidson, Selah Chamberlain, Frank W. Johnson; teachers, I. F. Stewart and Mrs. Alice P. Sweatman.

John Young Chinese night school.

St. Joseph's parochial school, off Valparaiso.

College of Notre Dame, Valparaiso.

William Warren School for Boys, Alejandro and El Camino Real.

St. Patrick's Seminary. A special section is devoted to the names of St. Patrick's Seminary.

Church of the Nativity, Oak Grove.

Presbyterian Church, Santa Cruz.

Trinity Episcopal Church, Oak Grove.

Native Daughters of the Golden West—Meetings in Native Sons' Hall.

Native Sons of the Golden West—Meetings in Native Sons' Hall first and third Thursdays.

Foresters of America—Meet in Native Sons' Hall.

Companions of the Forest—Meet in Native Sons' Hall.

GUIDE TO MENLO PARK STREETS

Numbered streets First to Eighteenth in Dumbarton Oaks.

Alameda de las Pulgas—From Woodside road south along front of the foothills to Santa Cruz avenue and beyond.

Alejandro avenue—First road north of Valparaiso, west from El Camino Real to Elena.

Alice street—First north of Middle, west from University to Columbia.

Arbor avenue—Fourth west of El Camino Real, north from Santa Cruz to Valparaiso.

Ashton street—Third road south of Valparaiso, west from Alameda de las Pulgas.

Atherton avenue—First road north of Alejandro, west from El Camino Real to Alameda de las Pulgas.

Avy street—Fifth south of Valparaiso, west from Alameda de las Pulgas.

Berkeley avenue—From Coleman east to Bay road.

Berkshire avenue—From Selby lane and El Camino Real east.

Bay road—From Dumbarton Oaks southeast along the bay shore to Ravenswood.

Camino al Lago—Continuation of Park, curving northward to Alameda de las Pulgas.

Camino de las Robles—Continuation of Park, curving southward to Alameda de las Pulgas.

Camino las Cerveos—Continuation of Park west to Alameda de las Pulgas.

Cambridge street, east—From Menlo south to College.

Cambridge street, west—Third road north of San Francisquito creek west to Yale from El Camino Real.

Cedar street, east—First road north of Alejandro, from El Camino Real to railroad.

Cedar street, west—First road north of Valparaiso, west from Alameda de las Pulgas.

Chestnut street—First west of El Camino Real north of Santa Cruz, from Oak Grove to Santa Cruz.

Cloud avenue—Eleventh street west of El Camino Real, from Santa Cruz north to Valparaiso.

Coleman avenue—From Ringwood south to College.

College street, east—From Coleman to Bay road.

College street, west—Fifth road north of San Francisquito creek, from El Camino Real west to Yale.

Columbia avenue—Fourth road west of El Camino Real, north from Stanford boulevard to Santa Cruz.

Crane avenue—Second street west of E Camino Real north of Santa Cruz, from Oak Grove south to Santa Cruz.

El Camino Real, County road or State Highway—From county line northwest to Redwood City, parallel with railroad, through center of Menlo Park.

Elena avenue—Third road west of El Camino Real north of Santa Cruz, from Atherton south to Valparaiso

Emilia street—Third street west of El Camino Real, from Santa Cruz north to Valparaiso.

Fair Oaks lane—From El Camino Real near Atherton avenue eastward two blocks.

Florence street—Second road north of Middle, west from University to Columbia.

Glenwood avenue—First road north of Oak Grove, east from El Camino Real to Middlefield.

Gordon street—Fourth north of Valparaiso, west from Alameda de las Pulgas.

Grove avenue—Seventh road west of El Camino Real, from Santa Cruz north to Valparaiso.

Harvard avenue—Second road north of San Francisquito creek, from El Camino Real west to Yale.

Laurel avenue—Second road north of railroad, from Fair Oaks lane south to Ravenswood.

Laurel street—First south of Valparaiso, west from Alameda de las Pulgas.

Leland avenue—From Vine southward to Stanford boulevard.

Madrono street—Fifth road north of Valparaiso, west from Alameda de las Pulgas.

Manzanita street—Fourth road north of Valparaiso, west from Alameda de las Pulgas.

Maple avenue, west—Eighth road west from El Camino Real, from Santa Cruz north to Valparaiso.

Maple avenue, east—First road south of Fair Oaks lane, from El Camino Real to railroad.

Menlo avenue, east—From Ringwood southeast to Bay road.

Menlo avenue, west—First road south of Santa Cruz, from University west to Santa Cruz.

Middle avenue—Sixth road north of San Francisquito creek, from El Camino Real west to Madrone.

Middlefield road—Third road east from the railroad, from San Francisquito creek northwest to Redwood City.

Mills avenue—First road east of railroad, from Oak Grove north to Glenwood.

Mills street—Sixth road north of Valparaiso, west from Alameda de las Pulgas

Oak avenue, west—Second road north of Valparaiso, west from Alameda de las Pulgas.

Oak avenue, east—From Menlo south to College.

Oak avenue, west—Second road north of Valparaiso, west from Alameda west to Elena.

Oakleigh avenue—From Selby west 1 block.

Oakley avenue—Second road south of Valparaiso, west from Alameda de las Pulgas.

Olive avenue—Sixth road west of El Camino Real, from Santa Cruz north to Valparaiso.

Orange avenue—Ninth road west of El Camino Real, from Santa Cruz north to Valparaiso.

Oxford avenue—From Menlo south to College.

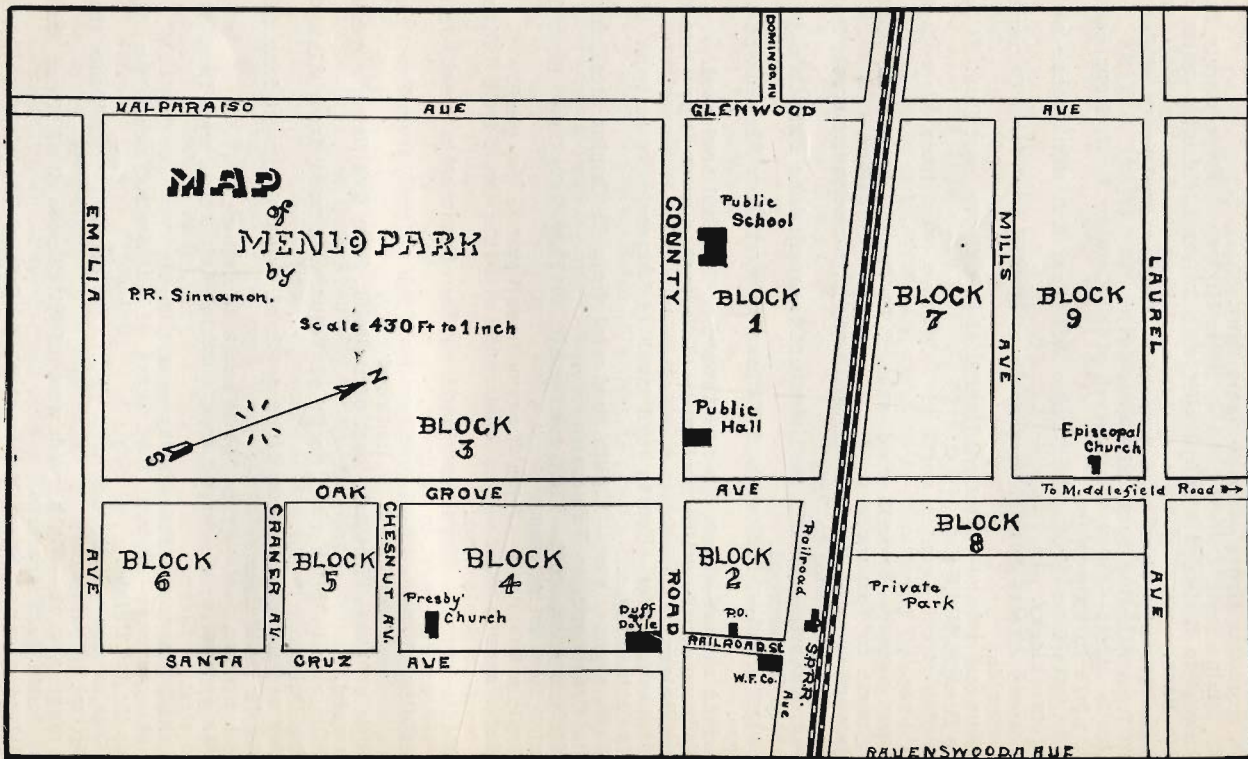

Park avenue—Continuation of Alejandro west to Camino al Lago; south at right angle to Stanford boulevard.

Partridge avenue—Fourth road north of San Francisquito creek, from El Camino Real west to Yale.

Palo Alto street—Second road south of Menlo, west of Park, from Vine to Leland.

Perry street—First road south of Menlo, west of Park, from Vine to Leland.

Pine street—Third road north of Valparaiso, west from Alameda de las Pulgas.

Polhemus avenue—First road north of Atherton, from Selby west to Alameda de las Pulgas.

Princeton street—Third road west of El Camino Real, north from Stanford boulevard to Middle.

Railroad or Merrill avenue—From Oak Grove south to Ravenswood.

Railroad street—Continuation of Santa Cruz to railroad.

Randall avenue—Second road north of Atherton from Selby west to Alameda de las Pulgas.

Ravenswood avenue—First road south of Oak Grove, east from El Camino Real to Middlefield.

Reservoir street—Seventh road north of Valparaiso, west from Alameda de las Pulgas.

Ringwood avenue—Continuation of Ravenswood east to Bay road.

Roble and Oak—First road south of Menlo, west from University.

San Mateo avenue—Fifth road west of El Camino Real, from Santa Cruz north to Valparaiso.

Santa Cruz avenue—Seventh road north of San Francisquito creek, west from El Camino Real, then southwest to Stanford boulevard.

Selby lane—First road north of Atherton, west from El Camino Real to Oakleigh; south at right angle to Atherton.

Sherman avenue—Tenth west of El Camino Real, from Santa Cruz north to Valparaiso.

Spruce street—First street south of Fair Oaks lane, from El Camino Real east to railroad.

Stanford avenue—From Vine southward to Stanford boulevard.

Stanford boulevard—First road north of San Francisquito creek, from El Camino Real westward to Madrone.

University avenue—Second road west of El Camino Real north from Stanford boulevard to Santa Cruz.

Vine avenue—Eighth road west of El Camino Real, from Stanford boulevard north to Menlo.

Walnut street—Second road south of Fair Oaks lane, from El Camino Real east to railroad.

Walsh street—Eighth road north of Valparaiso, west from Alameda de las Pulgas.

Watkins street—Third road south of Fair Oaks lane, from El Camino Real east to railroad.

Yale avenue—First road west of El Camino Real, from Stanford boulevard north to Middle.

A

- Aabel, J. T. (Luisa), machinist, Santa Cruz.
- Adam, Fred, Mrs. F.), Menlo Heights.
- Adams, Mrs. Alice A., Glenwood.
- Adams, Arthur, student, Glenwood.