

# MC NEEL DIRECTORY COMPANY'S MAPS OF SACRAMENTO COUNTY RURAL ROUTES

*From Sacramento Post Office and Stations*

**ROUTE ONE (From Oak Park Sta)** South on Franklin blvd serves areas east to Stockton blvd, west to Freeport blvd and south to Freeport Rd. P. 210

**ROUTE TWO (From Fort Sutter Sta)** Serves territory adjacent to Folsom blvd, Jackson road and Florin road, from Brighton-Florin road east approximately six miles. P. 211.

**ROUTE THREE.** Serves Gardenland, District 1000, north along Garden Highway and Power road to Sutter County, and approximately 15 miles in Yolo County along west side of Sacramento River. P. 212.

**ROUTE FOUR (From Oak Park Sta)** Serves districts east and west from Stockton blvd from 14th av south to Florin road including Fruitridge road, Lemon Hill av and Elder Creek road east to Hedge av. P. 213.

**ROUTE FIVE (From Fort Sutter Sta)** The Fair Oaks blvd route serves the area between American River and Auburn blvd east of Watt av, which includes Carmichael district. P. 214.

**ROUTE SIX.** Serves North Sacramento (north of Arcade Creek) Del Paso Heights, Robla and Rio Linda areas. P. 215.

**ROUTE SEVEN.** Auburn blvd, Edison av, Fulton av, and areas adjacent including Sierra Oaks and Sierra Oaks Vista on Fair Oaks blvd. P. 216.

**ROUTE EIGHT.** South on Riverside blvd along Sacramento River to 5 miles below Freeport and on west side of Sacramento River from Riverview north to West Sacramento; also serves areas adjacent to Davis Highway west to the causeway. P. 217.

### FROM OTHER COUNTY POST OFFICES

ELK GROVE—Routes 1 and 2.....	P. 218
FAIR OAKS.....	P. 221
FLORIN.....	P. 218
FOLSOM.....	P. 223
GALT—Routes 1 and 2.....	P. 219
RIO LINDA.....	P. 220
ROSEVILLE (In Sacramento County.....	P. 222
SACRAMENTO COUNTY.....	P. 208-9
WALNUT GROVE.....	P. 224
WILTON.....	P. 223

### ON THE MAPS

**HEAVY BLACK LINES** indicate Routes.

**ARROWS** denote direction in which delivery is made.

**NUMBERS** are Box Locations. Boxes are numbered consecutively.

**SOLID LINES** are other roads or streets.

**CIRCLES** indicate miles from Post Office.

*Refer to NUMERICAL DIRECTORY for definite  
Box Locations.*

MAPS

NUMERICAL

CLASSIFIED

SACRAMENTO COUNTY

(1941) MCNEEL DIRECTORY COS

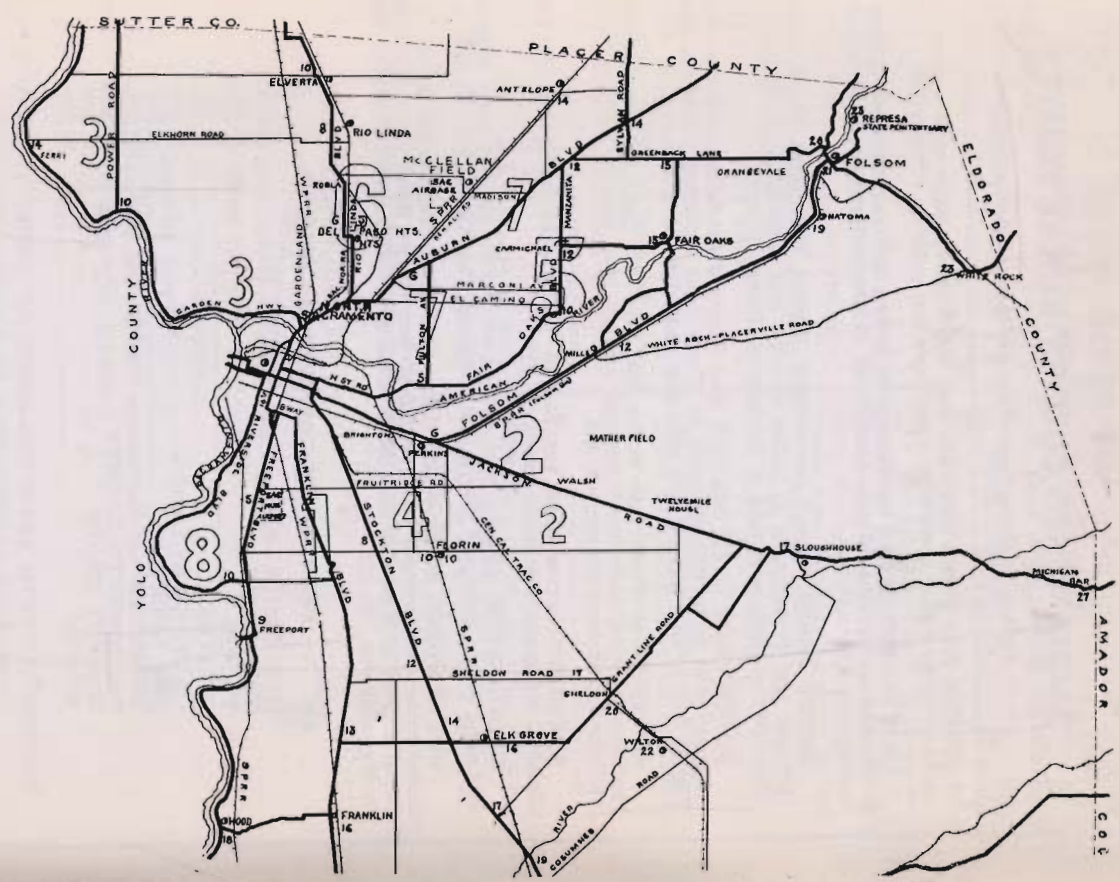

16th & K  
**MILLER & K**  
**AUTOMOBILE CO.**  
 DODGE AND PLYMOUTH SALES AND SERVICE  
 Tel. 3-5951

SACRAMENTO COUNTY RURAL DIRECTORY (1941)

SACRAMENTO COUNTY



MAP OF Sacramento County

- Post Offices
- FIGURES - MILES FROM SACRAMENTO P.O.
- MAIN ROADS
- - - OTHER ROADS
- LARGE FIGURES - SAC RURAL ROUTE AREAS

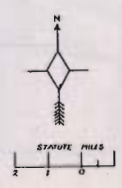

# Bring Your Farm Land Problems To

# Wright & Kimbrough

819 J STREET, SACRAMENTO

TELEPHONE 2-1991

210

SACRAMENTO COUNTY RURAL DIRECTORY (1941)

## RURAL ROUTE ONE

(Refer to Numerical Directory for definite box locations)

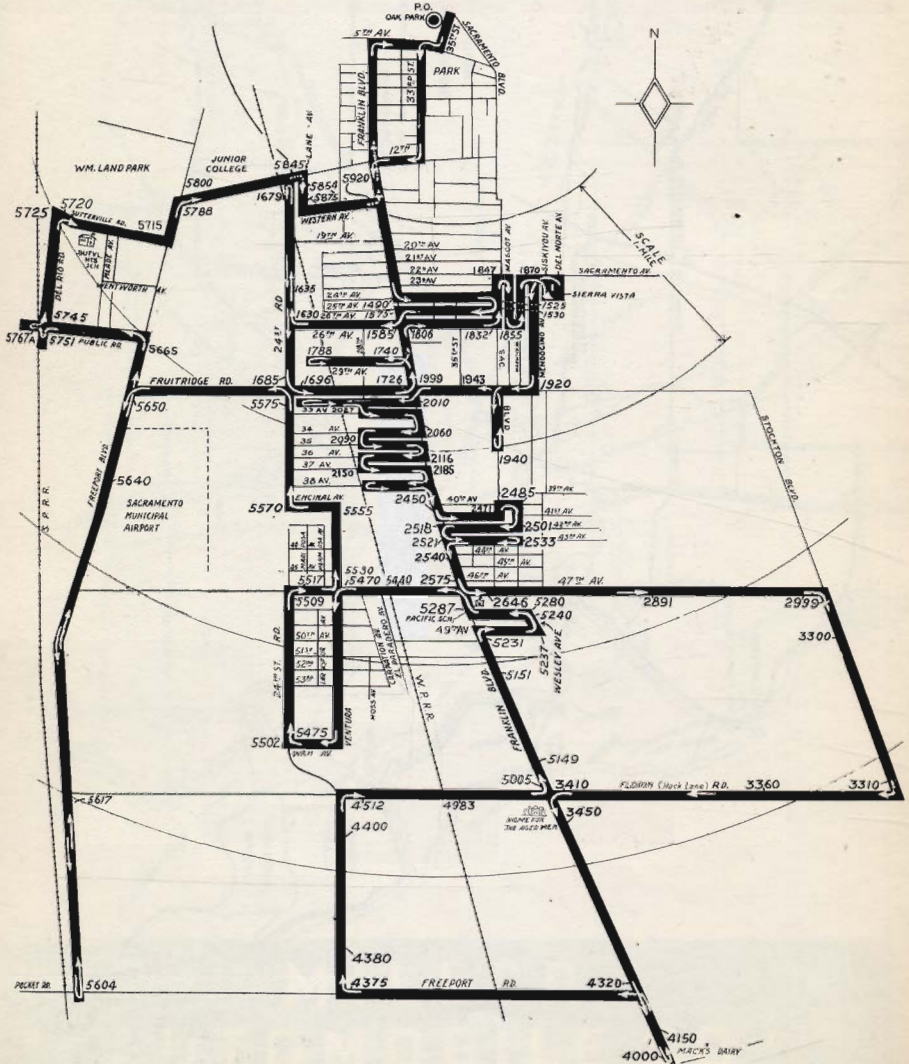



# ALL KINDS OF FARMS AND STOCK RANCHES

FARM AND AUTOMOBILE INSURANCE A SPECIALTY

## FLEMING & WALTER

906 J STREET, SACRAMENTO

PHONE 2-4986

212

(1941) McNEEL DIRECTORY CO'S

### RURAL ROUTE THREE

(Refer to Numerical Directory for definite box locations)

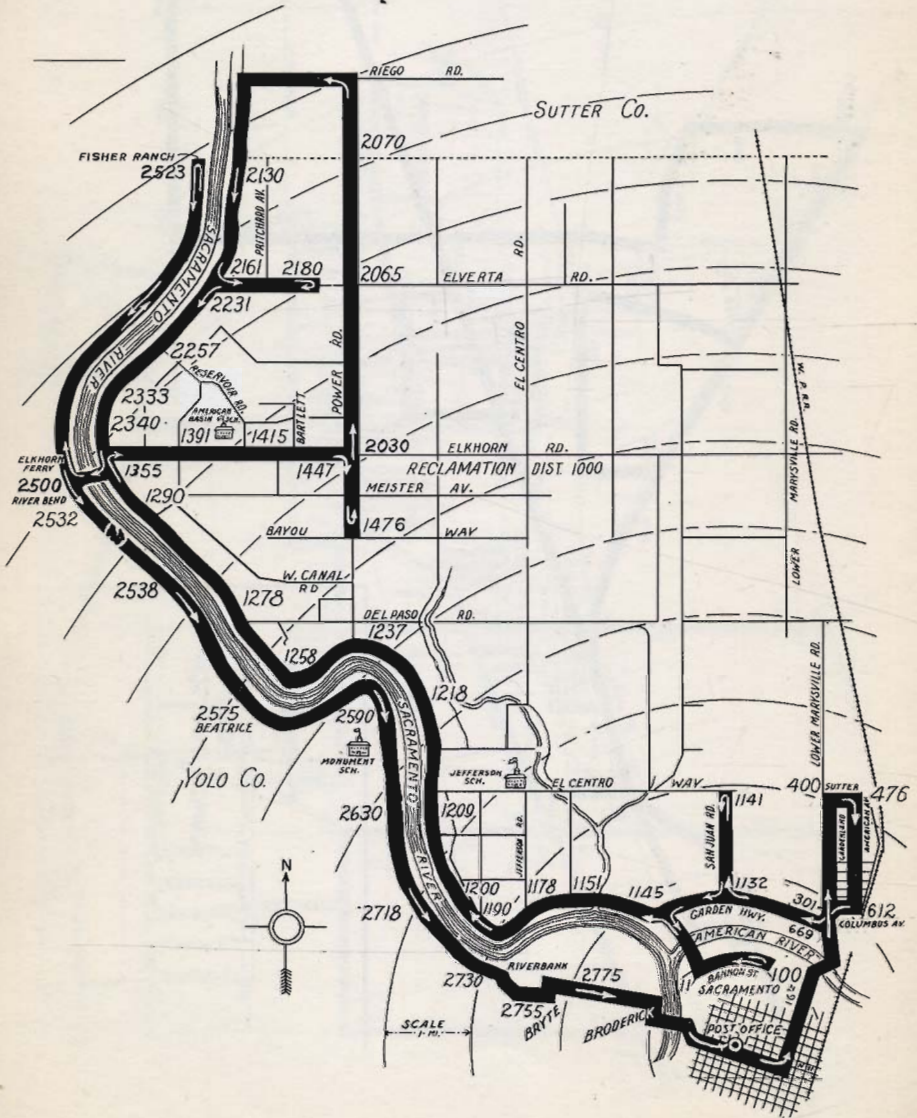

# The National Mercantile Agency

• LICENSED AND BONDED •

4th Floor Nicolaus Bldg.

1020-8th Street

Tel. 3-3704

SACRAMENTO COUNTY RURAL DIRECTORY (1941)

213

## RURAL ROUTE FOUR

(Refer to Numerical Directory for definite box locations)

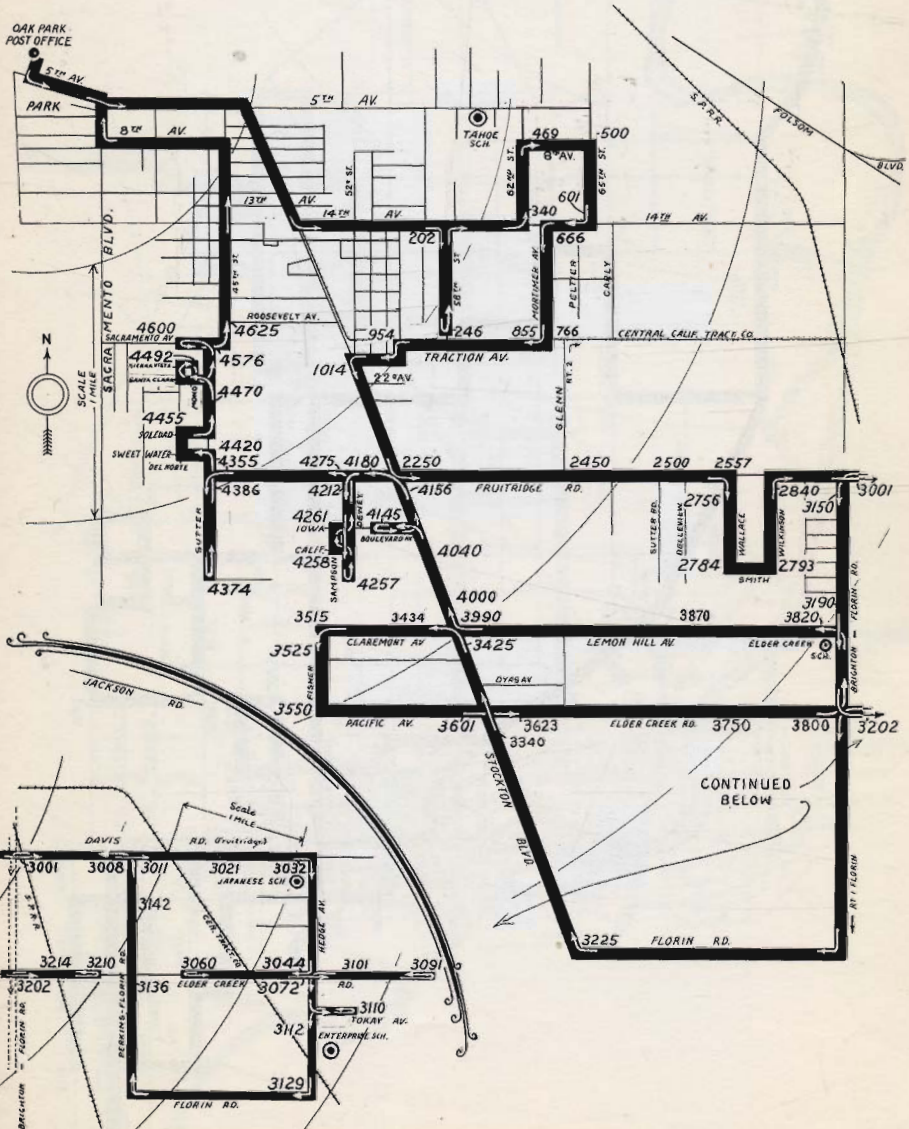

# RURAL ROUTE FIVE

(Refer to Numerical Directory for definite box locations)

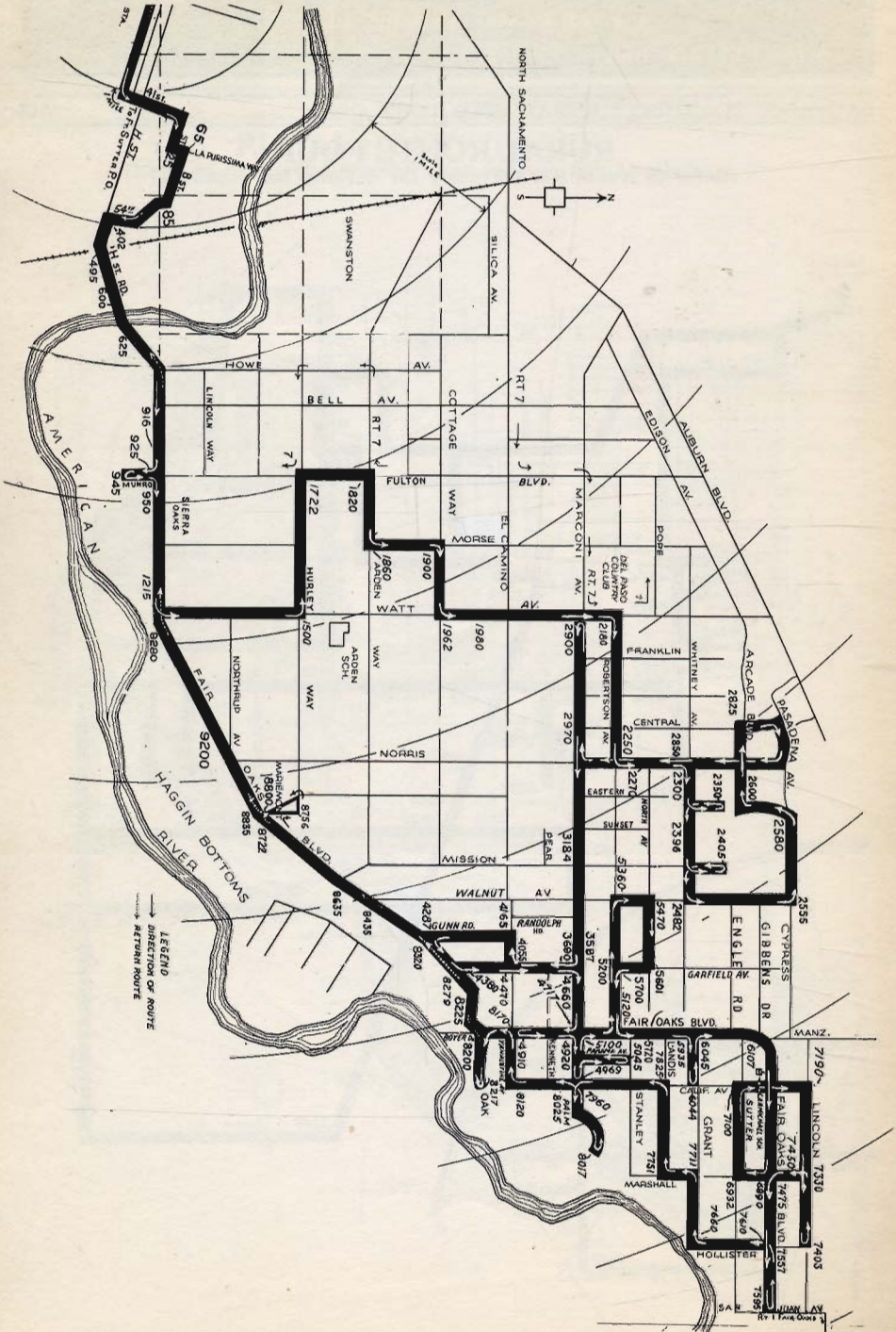

# Board of Trade of Sacramento County

SPECIALISTS IN THE LIQUIDATION OF PAST DUE ACCOUNTS

Personal Service in Northern California

107 OCHSNER BLDG., SACRAMENTO

TELEPHONE 2-0454

## RURAL ROUTE SIX

(Refer to Numerical Directory for definite box locations)

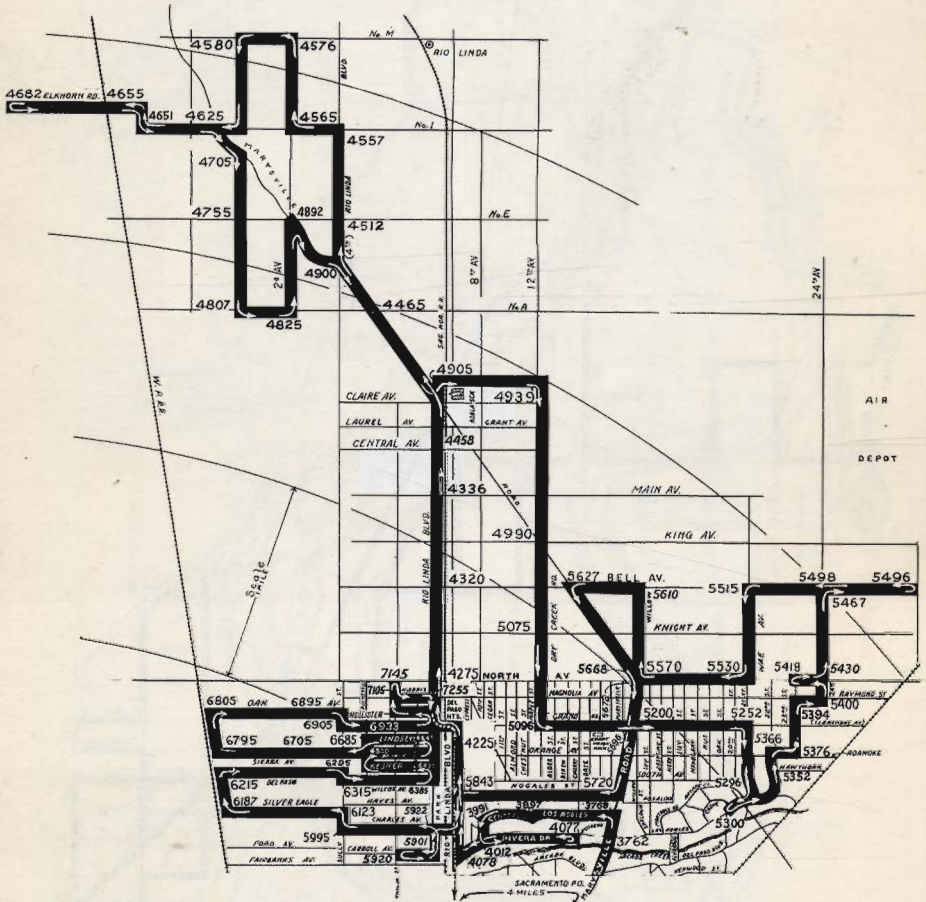



# Termite and Pest Control

SCIENTIFIC CONTROL OF ALL PESTS AND WOOD DISEASES

## GARLINGHOUSE & HOLLAND

1019 J St.

Tel. Cap. 5254, Dial 2-2027

216

(1941) McNEEL DIRECTORY CO'S

### RURAL ROUTE SEVEN

(Refer to Numerical Directory for definite box locations)

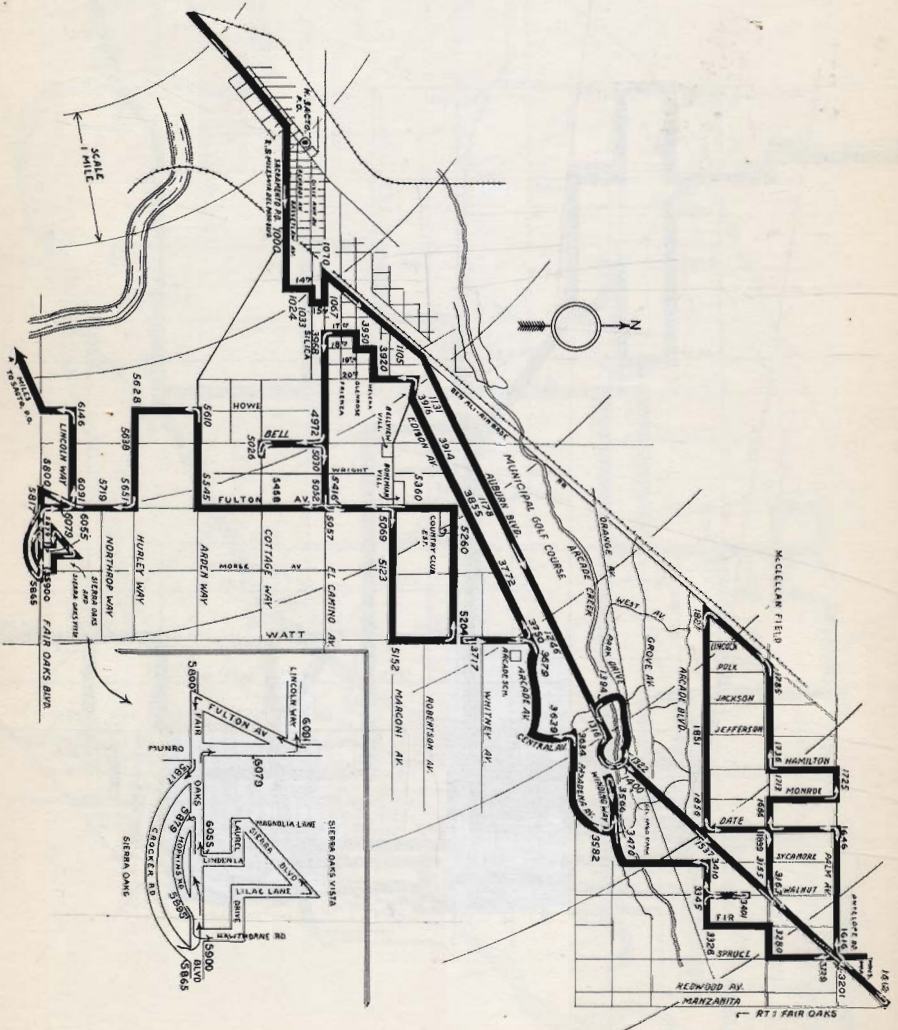

# RURAL ROUTE EIGHT

(Refer to Numerical Directory for definite box locations)

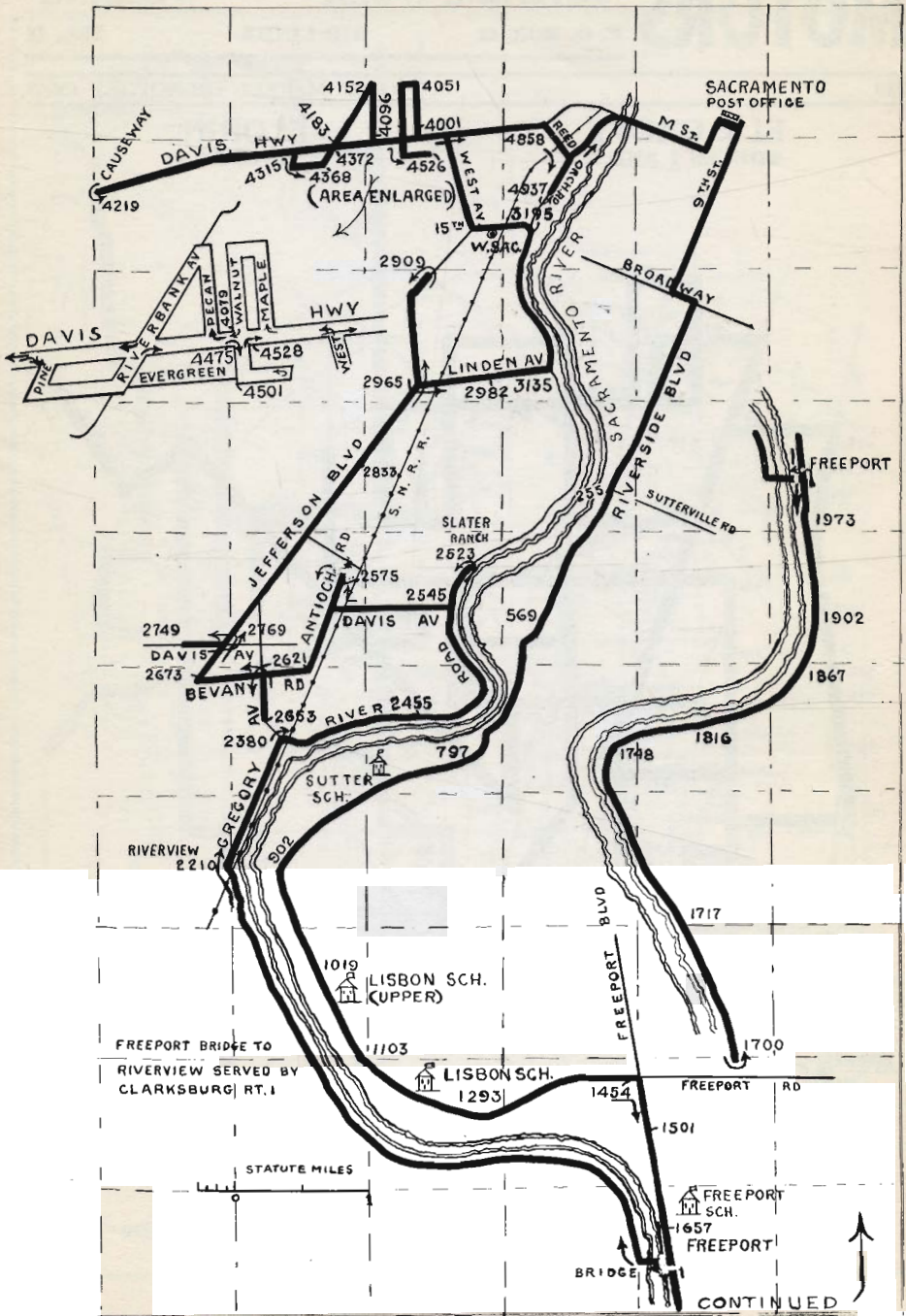

# PUMPS Sherman's Electric Works

# MOTORS MACHINE WORK WELDING

JOHN SHERMAN

P. O. BOX 43

RIO LINDA

TEL. 18

## ELK GROVE ROUTES 1 AND 2

## FLORIN ROUTE 1

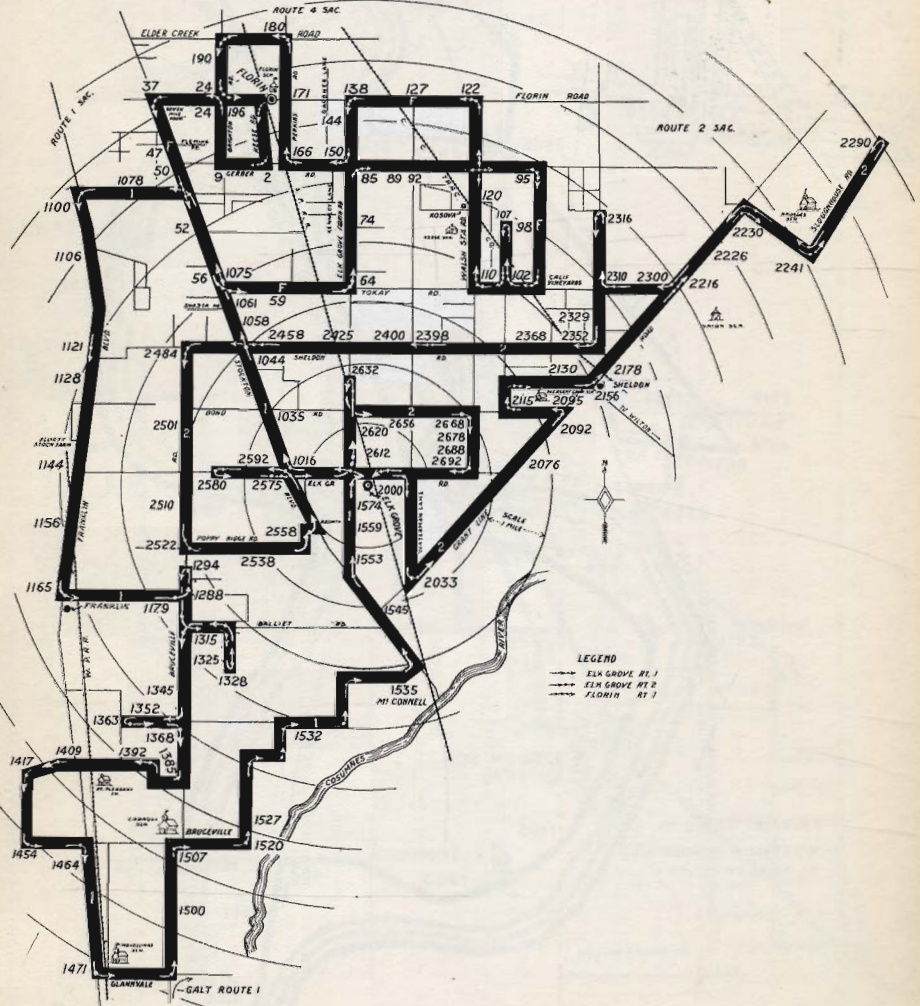



# DONSING BREEDING FARM and HATCHERY

BREEDERS OF "DONSING" WHITE LEGHORNS

"MORE EGGS PER HEN"

P. O. BOX 8

RIO LINDA

TELEPHONE 36M

220

(1941) McNEEL DIRECTORY CO'S

## RIO LINDA ROUTE ONE

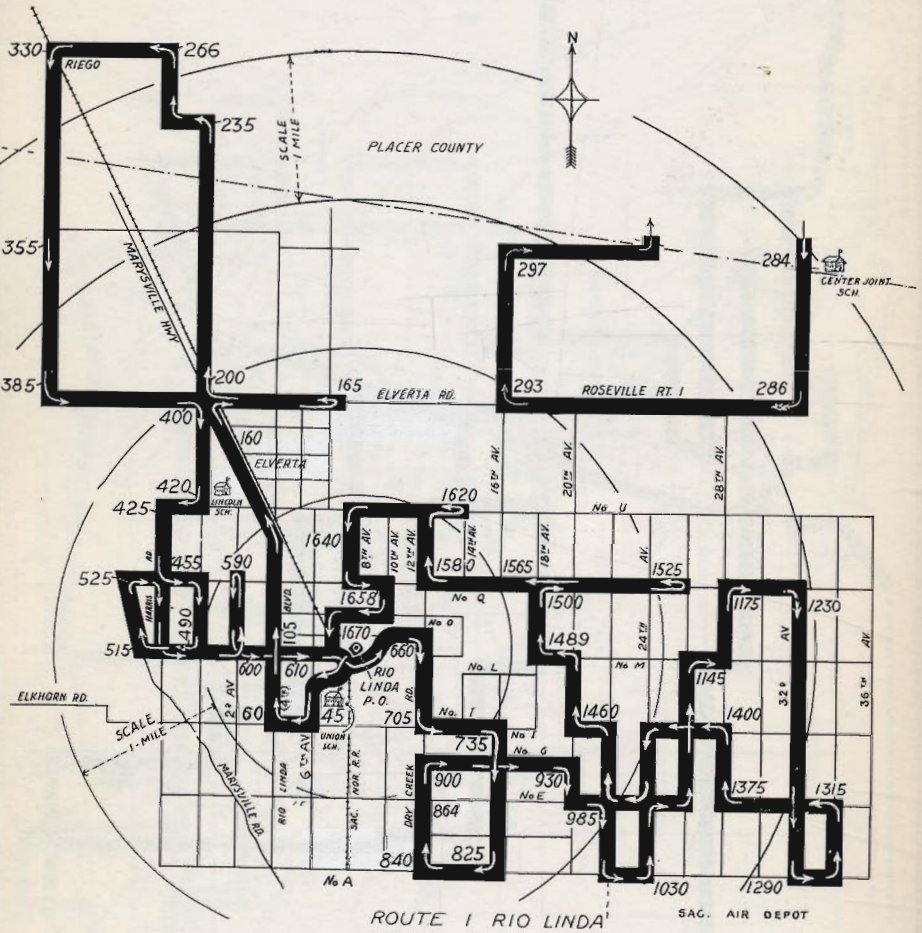

# GLOBE

TRANSFER & WAREHOUSE CO.

PROMPT — EFFICIENT — RELIABLE

ECONOMICAL

CITY **Delivery Service** RURAL

MOVING — STORAGE — HAULING

FRONT & N

TEL. MAIN 729

SACRAMENTO COUNTY RURAL DIRECTORY (1941)

221

## FAIR OAKS ROUTE ONE

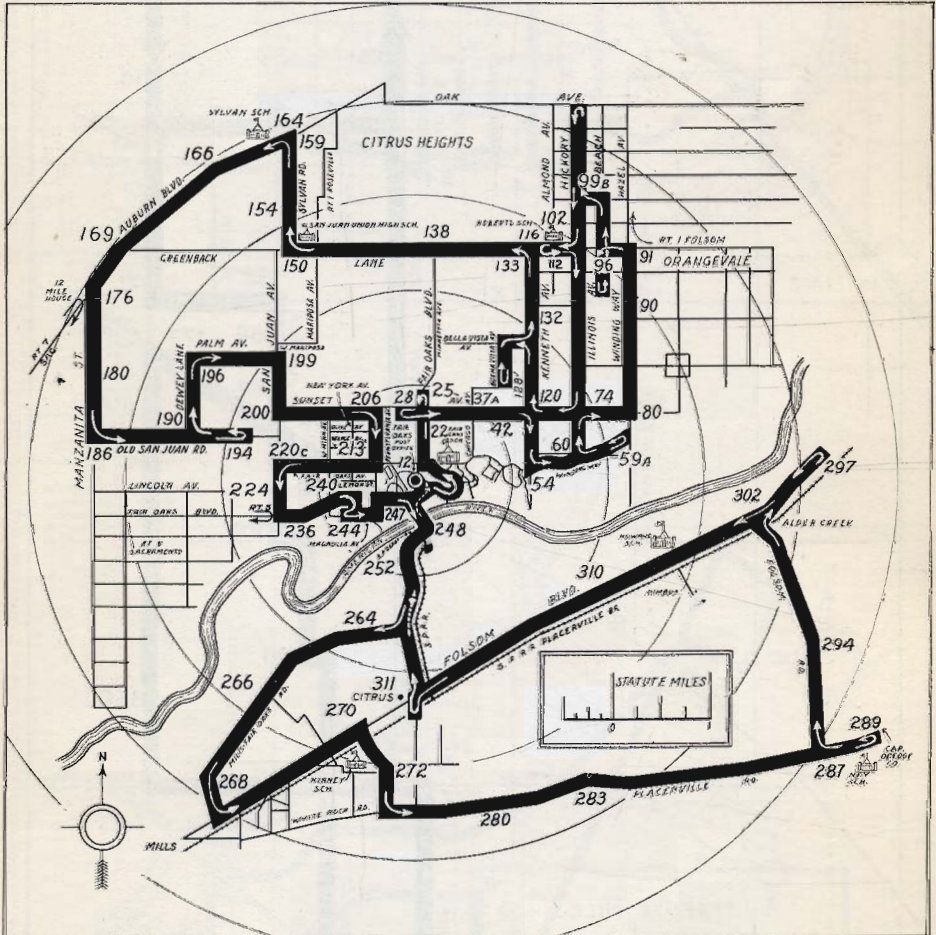



### FOLSOM ROUTE ONE

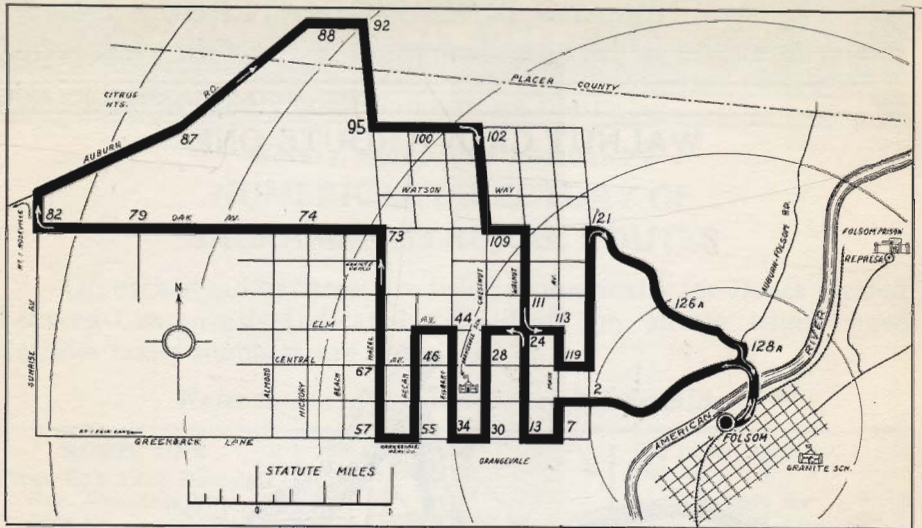

### WILTON ROUTE ONE

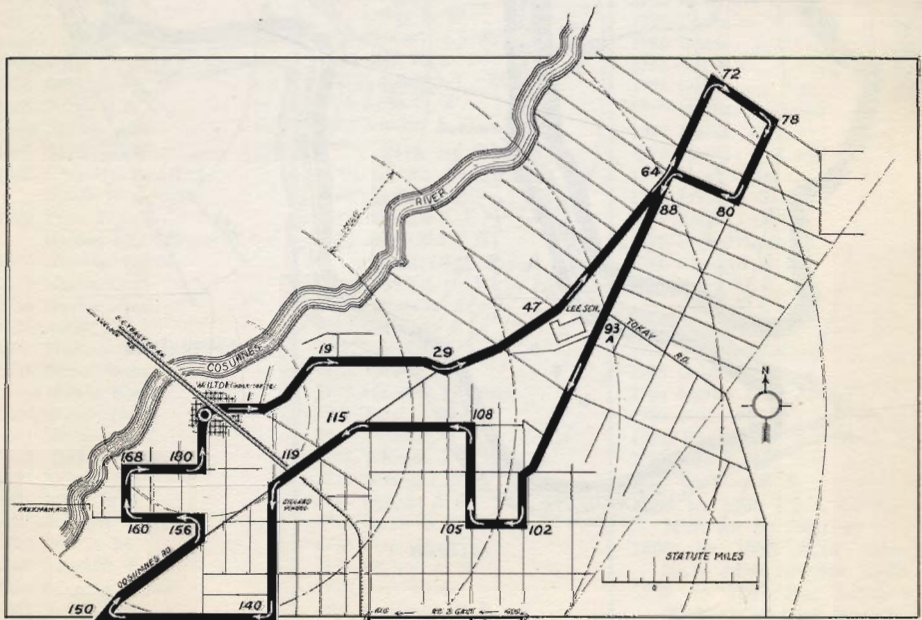



# THE DIAMOND MATCH CO.

## LUMBER AND BUILDING MATERIALS

Sacramento, 29th Cor. Q Tel. 6-4703 E. El Camino Av., Tel. 9-2741, No. Sacramento

### WALNUT GROVE ROUTE ONE

